

P-7-137

Plan of Survey

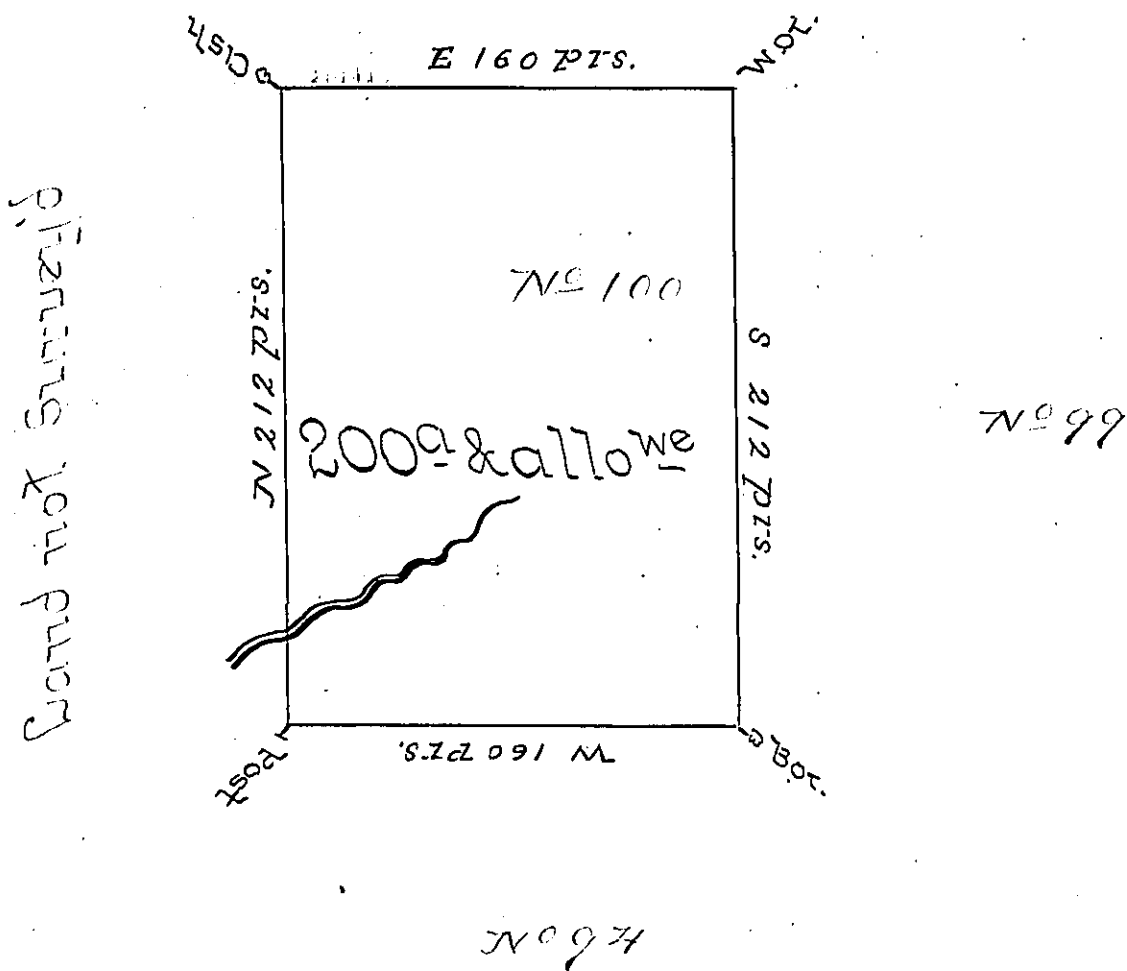

The above is a Draught of a Survey made in July 1755  
 Pursuance of Instructions from the Surveyer General  
 Dated the 9th day of April 1755 Situate on the North side  
 of the Alleghany River on the Waters of Pine Creek and  
 Little Run in the East Part of District No 3 Containing  
 Two Hundred acres of Land & Allowance of six Percent &c

Saml Jones

To John Bickers Esq:  
Survey General

IN TESTIMONY that the above is a copy of the original remaining on file in  
 the Department of Internal Affairs of Pennsylvania, made  
 conformably to an Act of Assembly approved the 16th day of  
 February, 1833, I have hereunto set my Hand and caused  
 the Seal of said Department to be affixed at Harrisburg,  
 this first day of November 1898

*James W. Latta*  
 Secretary of Internal Affairs.